

Brian Roberts

From: Zachary Szuminski <Zachary.Szuminski@hardi.com>
Sent: Tuesday, April 11, 2023 11:31 AM
To: Brian Roberts
Subject: RE: DROP TUBES

This is what they look like.

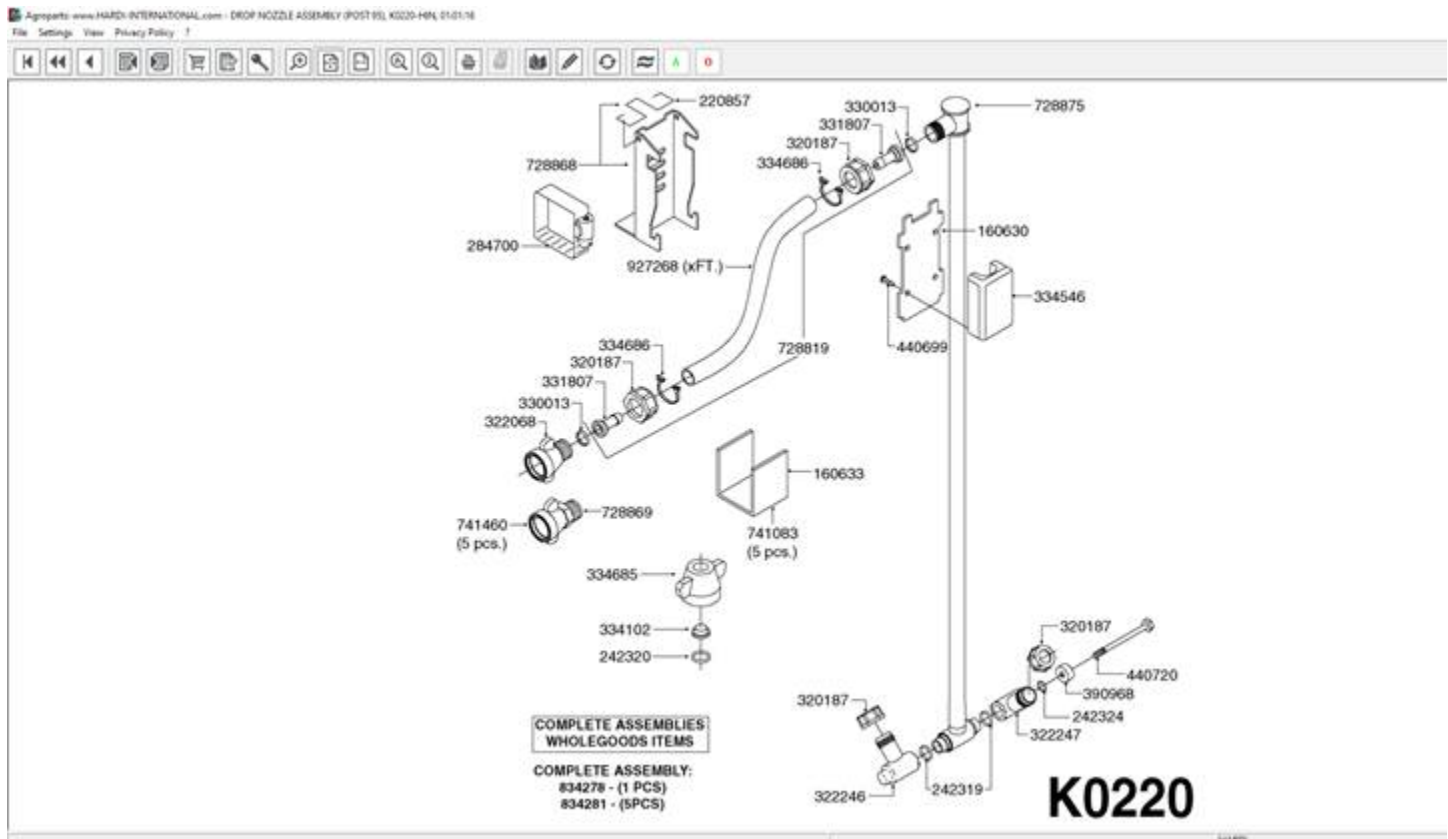

Best regards

Zachary Szuminski | Territory Manager
email: zachary.szuminski@hardi.com
office: 563-386-6688

From: Brian Roberts <broberts@solexcorp.com>
Sent: Tuesday, April 11, 2023 1:29 PM
To: Zachary Szuminski <Zachary.Szuminski@hardi.com>
Subject: RE: DROP TUBES

Ok, thanks for letting me know.

Do you have a picture of the Drop Tube.

Regards
Brian

From: Zachary Szuminski <Zachary.Szuminski@hardi.com>
Sent: Tuesday, April 11, 2023 11:21 AM
To: Brian Roberts <broberts@solexcorp.com>
Subject: RE: DROP TUBES

Hi Brian,

The only drop tubes we offer are 83427803 for individual or a box of 5 which is part number 834281.

Best regards

Zachary Szuminski | Territory Manager
email: zachary.szuminski@hardi.com
office: 563-386-6688

From: Brian Roberts <broberts@solexcorp.com>
Sent: Tuesday, April 11, 2023 9:27 AM
To: Zachary Szuminski <Zachary.Szuminski@Hardi.com>
Subject: DROP TUBES

Dear Zach

I have a Customer with a Ranger 550 from 2013.

He is asking if you can provide the drop tubes (2 ft Long) for use with Liquid Fertilizer

Regards
Brian