

# Service Parts

## Driver Assembly

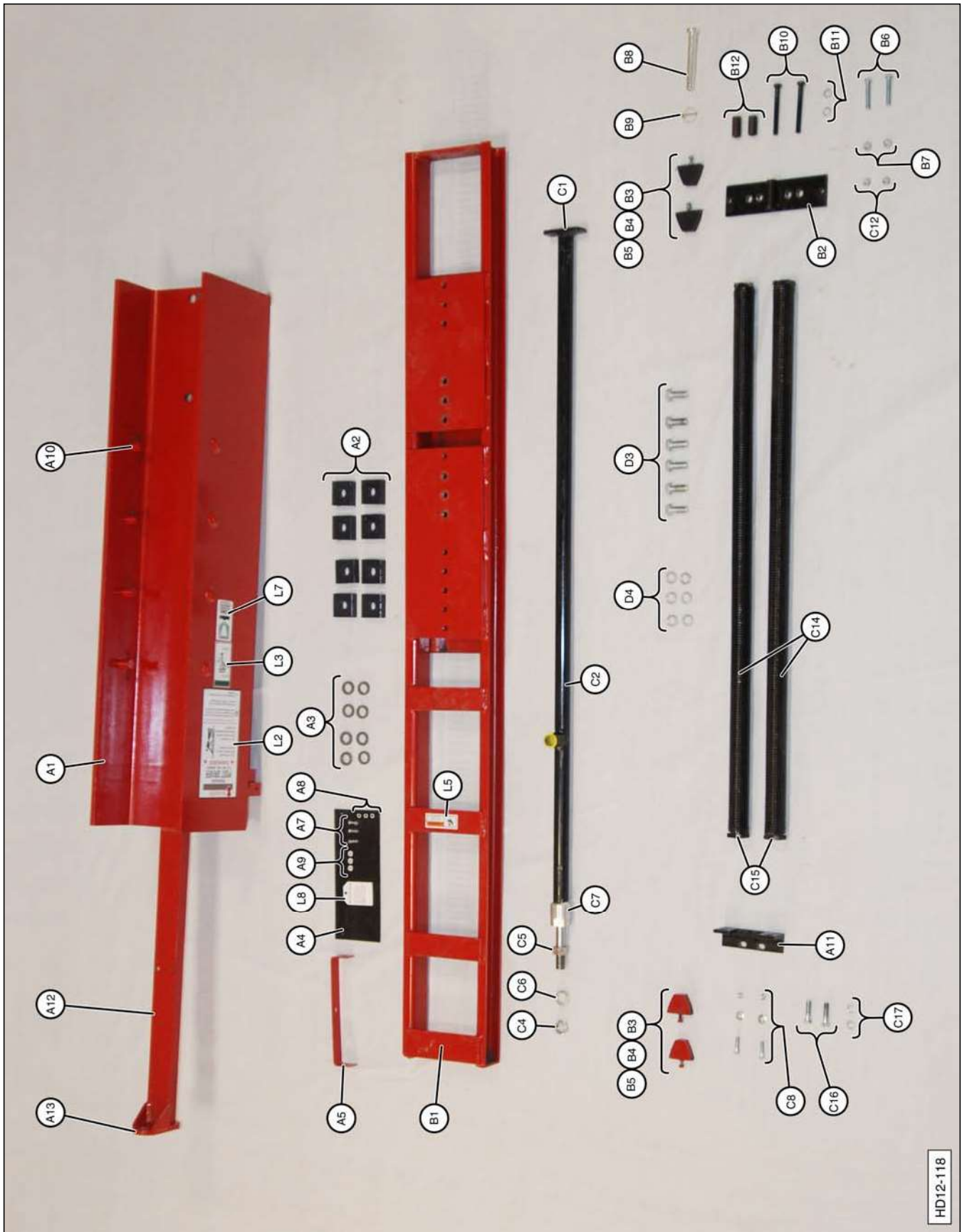

HD12-118

## Driver Assembly

HD-12-H Service Parts - Driver Assembly			
Item No.	Part No.	Description	Qty.
A1	SM-1211-DRC	Driving Ram Complete	1
	SM-1211-DRO	Driving Ram Only	1
A2	SM-00512	Guide Block (Pkg. of 4)	2
A3	SM-0933-(18 ga)	Shim	4
	SM-0934-(14 ga)		
	SM-0935-(10 ga)		
A4	SM-1211-G	Rubber Debris Guard <sup>1</sup>	1
A5		Guard Mounting Strap	1
L8		Caution Tag	1
A7		Guard Mounting Bolt	3
A8		Guard Mounting Washer	3
A9		Guard Mounting Nut	3
A11	SM-1211-SBU	Upper Spring Bracket	1
B1	SM-12412	Main Carriage Channel	1
B2	SM-1241-RLB	Road Lock Bracket (no pin)	1
B3	SM-0041-B	Rubber Bumper <sup>2</sup>	4
B4		Bumper Lock Washer, 5/16	4
B5		Bumper Nut, 5/16-18	4
B6	SM-093	Road Lock Bracket Bolt	2
B7	SM-0932	Road Lock Bracket Nut	2
B8	SM-1041-RLP	Road Lock Pin	1
B9	SM-1041-RLC	Road Lock Pin Clip	1
C1	SM-1026	Cylinder Assembly	1
C2	SM-10261	Cylinder Tube	1
C3	SM-10266	Cylinder Piston/Rod	1
C4	SM-10267	Piston Self-Locking Nut	1
C5	SM-018	Cylinder Nut (with setscrew)	1
C6	SM-10268	Lock Washer	1
C7	SM-10262-D	Cylinder Cap (with seal)	1

HD-12-H Service Parts - Driver Assembly (continued)			
Item No.	Part No.	Description	Qty.
C8	—	Bolts, Lock Washers, Nuts (upper spring bracket)	2
C12	SM-0931	Lower Bracket Lock Nut	2
C13	SM-1211-SCL	Spring Mount Lower	2
C14	SM-1211-DRS	Spring Complete (with spring mounts installed)	2
C15	SM-1211-SCU	Spring Mount Upper	2
C16	—	Upper Spring Mt. Bolt	2
C17	—	Upper Spring Mt. Washer	2
D3	S-012	Short Bracket Bolts 5/8-11 x 1-1/4	4
D4	S-013	Short Bracket Lock Washer 5/8	4
L2	MS-161	Large "SHAVER" Decal	1
L3	MS-169	Control Valve Decal	1
L5	MS-181	Pinch Area Warning Decal	1
L7	MS-280	FEMA Member Decal	1
L9	MS-180	Cylinder Shaft Loose Decal (not visible)	1

<sup>1</sup> SM-1211-G Includes Items A4, A5, L8, A7, A8, and A9.

<sup>2</sup> SM-0041-B Includes Items B3, B4, and B5.

## Drive Ram Weldment Parts

HD-12-H Service Parts - Drive Ram Weldment			
Item No.	Part No.	Description	Qty.
A10	SM-1011-BS	Block Stud <sup>1</sup>	8
A12	SM-1211-LYB	Lift Yoke Bar <sup>1</sup>	1
A13	SM-1211-LYT	Lift Yoke Top <sup>1</sup>	1

<sup>1</sup> Replacement of these parts requires removal of old parts with a cutting torch and/or grinding wheel. New (replacement) parts must be welded to drive ram. This type of repair voids any warranties.