

ENCODER 360 WHEEL ASSEMBLY

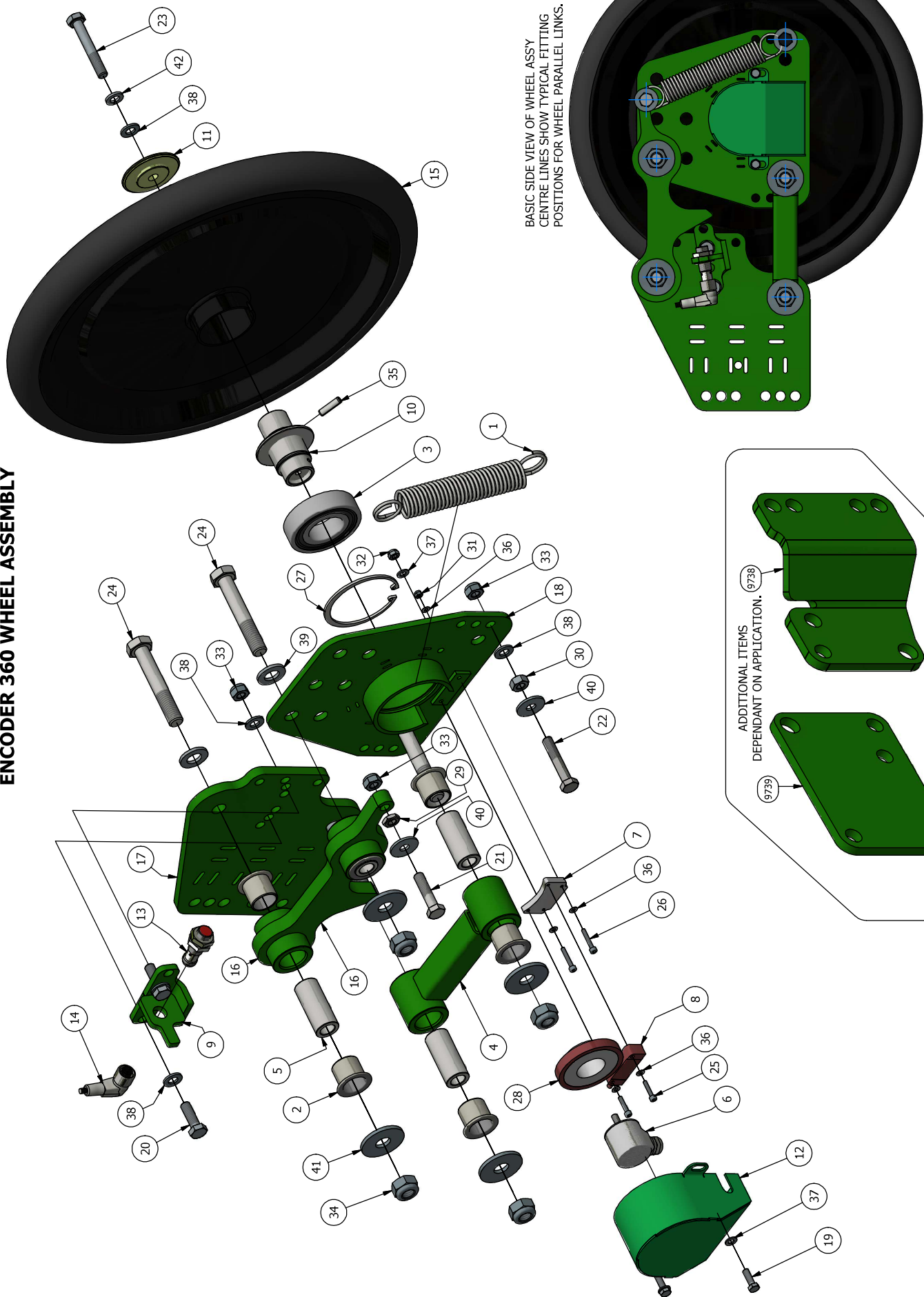

BASIC SIDE VIEW OF WHEEL ASSY
CENTRE LINES SHOW TYPICAL FITTING
POSITIONS FOR WHEEL PARALLEL LINKS.

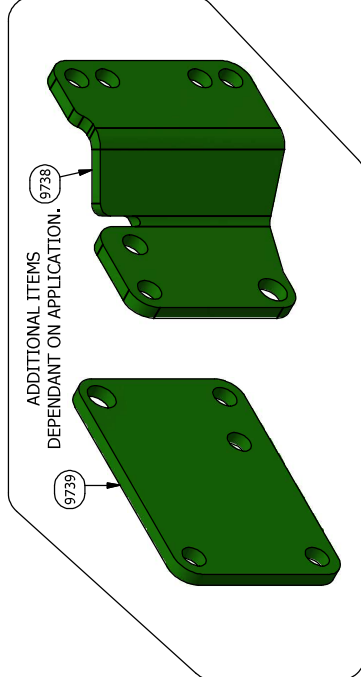

ENCODER 360 WHEEL ASSEMBLY

ITEM	PART DESCRIPTION	PART NUMBER	QTY
1	TENSION SPRING	6595	1
2	BUSH	8185	8
3	BEARING	8554	1
4	PARALLEL LINK	8645	1
5	AXEL FOR PARALLEL LINKS	8646	4
6	ENCODER	9347	1
7	MAGNET RING SENSOR MOUNT	9802	1
8	MAGNET RING SENSOR	9807	1
9	LIFT SENSOR BRACKET	9856	1
10	SHAFT FOR ENCODER WHEEL	9860	1
11	ENCODER WHEEL CAP	9861	1
12	ENCODER WHEEL GUARD	9862	1
13	NPN PROXIMITY SENSOR C/W NUTS	10121	1
14	PROXIMIT SENSOR PLUG	10122	1
15	ENCODER WHEEL, 360 DIA	10846	1
16	PARALLEL LINK	10847	1
17	MOUNTING BRACKET	10848	1
18	BEARING HOUSING BRACKET	10849	1
19	BOLT M5 X 16 SET BZP	Bolt M5 x 16 set Bzp	2
20	BOLT M5 X 25 SET BZP	Bolt M8 x 25 set Bzp	2
21	BOLT M8 X 35 BZP	Bolt M8 x 35 Bzp	1
22	BOLT M8 X 45 BZP	Bolt M8 x 45 Bzp	1
23	BOLT M8 X 55 BZP	Bolt M8 x 55 Bzp	1
24	BOLT M8 X 75 BZP	Bolt M12 x 75 Bzp	4
25	BOLT SOCKET CAP M3 X 16 BZP	Bolt Socket Cap M3 x 16 BZP	2
26	BOLT SOCKET CAP M3 X 20 BZP	Bolt Socket Cap M3 x 20 BZP	2
27	CIRCLIP 62X2 INT STD	Circlip 62x2 Int Std	1
28	MAGNET RING	MAGNET RING 50 056x025	1
29	NUT HALF M8	Nut Half M8 Bzp	1
30	NUT M8	Nut M8 Bzp	1
31	NUT NYLOC M3	Nut nyloc M3	2
32	NUT NYLOC M5	Nut nyloc M5	2
33	NUT NYLOC M8	Nut nyloc M8	4
34	NUT NYLOC M12	Nut nyloc M12	4
35	ROLL PIN - 5 x 20	ROLL PIN - 5 x 20	1
36	WASHER FLAT M3 FORM A BZP	Washer flat M 3 form A Bzp	6
37	WASHER FLAT M5 FORM A BZP	Washer flat M 5 form A Bzp	4
38	WASHER FLAT M8 FORM A BZP	WASHER FLAT M 8 FORM A BZP	7
39	WASHER FLAT M12 FORM A BZP	Washer flat M 12 form A Bzp	4
40	WASHER RET FLAT M 8X24X2 BZP	Washer ret flat M 8x24x2 Bzp	2
41	WASHER RET FLAT M 12X37X3 BZP	WASHER RET FLAT M 12X37X3 BZP	4
42	WASHER SPRING - M 8 BZP F SECTION	WASHER SPRING - M 8 BZP F SECTION	1