

# PEPIN HARROW

G-121

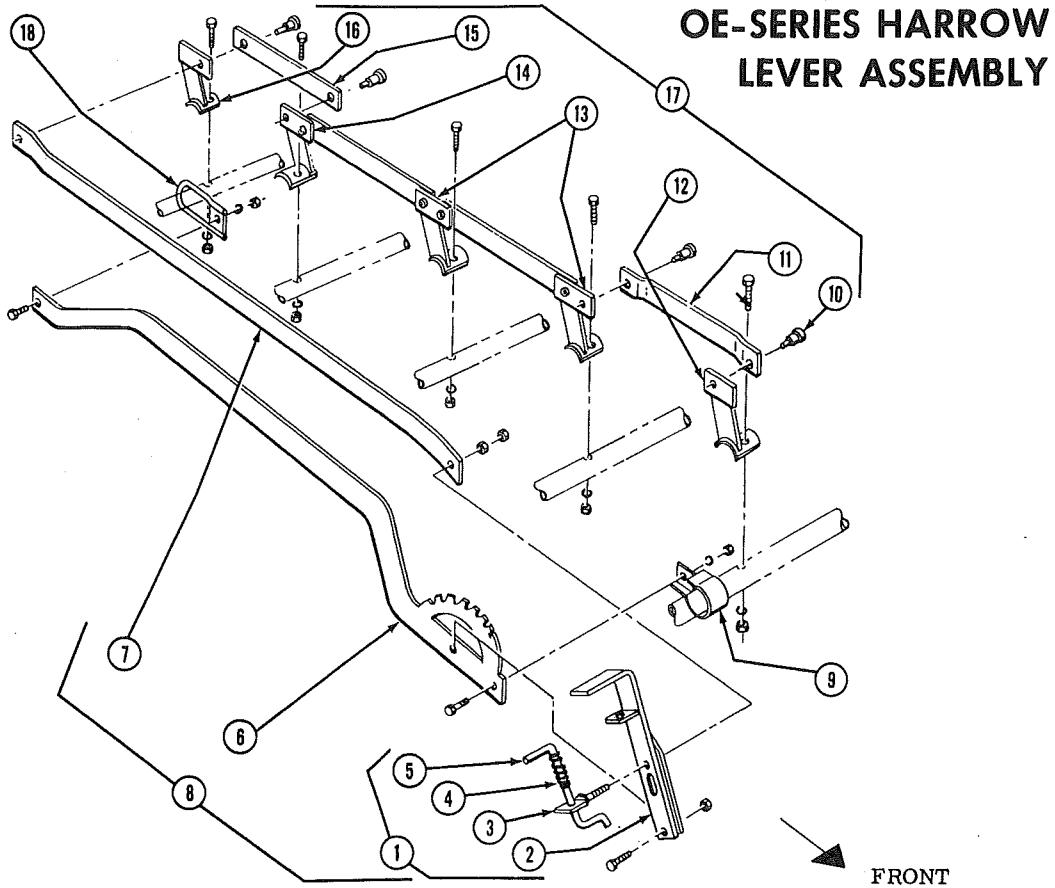

4 1/2

## REPAIR PARTS

Item	Description	Model and Part Number				
		OE-55-1/2	OE-645	OE-6	OE-6-1/2	OE-7
1	Lever assembly, complete	OE-17	OE-17	OE-17	OE-17	OE-17
2	Lever	OE-24	OE-24	OE-24	OE-24	OE-24
3	Bolt, plunger to lever	P-37	P-37	P-37	P-37	P-37
4	Coil spring, lever	OE-19	OE-19	OE-19	OE-19	OE-19
5	Plunger, lever	OE-18	OE-18	OE-18	OE-18	OE-18
6	Reach bar w/quadrant	OE-15A	OE-15A	OE-15A	OE-15A	OE-15A
7	Reach bar, rear standard to lever	OE-7	OE-7	OE-7	OE-7	OE-7
8	Complete tilting bar and lever assembly	OE-6A	OE-6A	OE-6A	OE-6A	OE-6A
9	Reach bar clip, front	OE-14A	OE-14A	OE-14A	OE-14A	OE-14A
10	Rivet, shouldered, short	P-46	P-46	P-46	P-46	P-46
11	Tilting bar link, front	OE-25	OE-25	OE-25	OE-25	OE-25
12	Standard, left, front bar	OE-13A	OE-13A	OE-13A	OE-13A	OE-13A
13	Standard, left, No. 2 and No. 3 bar	OE-12A	OE-12A	OE-12A	OE-12A	OE-12A
14	Standard, right, No. 4 bar	OE-10A	OE-10A	OE-10A	OE-10A	OE-10A
15	Tilting bar link	OE-11	OE-11	OE-11	OE-11	OE-11
16	Standard, left, rear	OE-9A	OE-9A	OE-9A	OE-9A	OE-9A
17	Tilting bar and standard assembly	OE-8A	OE-8A	OE-8A	OE-8A	OE-8A
18	Reach clip, rear	OE-16A	OE-16A	OE-16A	OE-16A	OE-16A

## ASSEMBLY INSTRUCTIONS

Control lever and tilting bars are assembled at the factory. Position the lever assembly on the harrow with the lever to the front. Fasten the reach bars to the front and rear bar clips. Bolt the standards to the pipe bars, as shown in the illustration. **MAKE SURE ALL CAP SCREWS, LOCK WASHERS AND NUTS ARE TIGHT!**

DIXON



CALIF