

# IN-ROW WEEDING DISC SIZES & LEGS

## PLANT ZONE 6cm

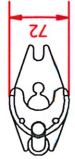

16-4W6 8683.QR



18-4W6 8683.QR



21-4W6 8496.QR



## PLANT ZONE 7cm

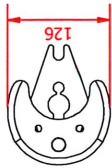

25-4W7 8496.QR

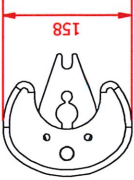

29-4W7 8496.QR

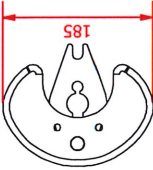

33-4W7 8496.QR



## PLANT ZONE 10cm



29-6W10 8511.QR

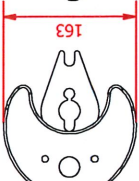

33-6W10 8511.QR

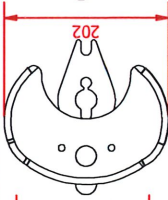

38-6W10 8511.QR

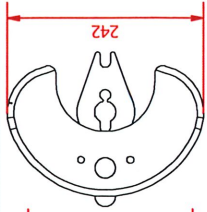

45-6W10 8511.QR

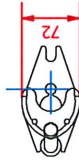

16-4W6 8543.QR

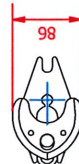

18-4W6 8543.QR



21-4W6 8495.QR



25-4W7 8495.QR

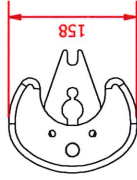

29-4W7 8495.QR

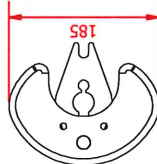

33-4W7 8495.QR

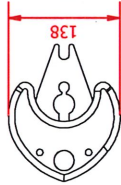

29-6W10 8684.QR

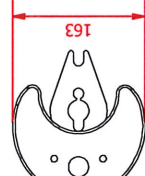

33-6W10 8684.QR

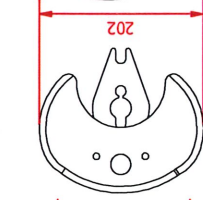

38-6W10 8684.QR

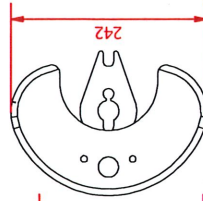

45-6W10 8684.QR



29-4W7 = Nominal max plant spacing 29cm, Rotor center line to row offset 4cm, Weeding W, Plant clearance zone 7cm

# IN-ROW THINNING & SPECIAL DISC SIZES & LEGS

## THINNING DISC



18-4T4 8683.QR



18-4T5 8683.QR



21-4T5 8683.QR

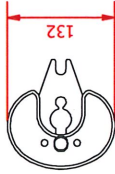

21-4T6 8683.QR

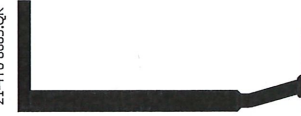

## SPECIAL DISC LEGS

### PLANT ZONE 6cm



21-4W6 10441.QR

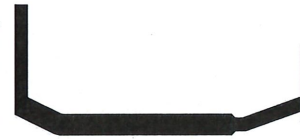

### PLANT ZONE 7cm



25-4W7 10441.QR

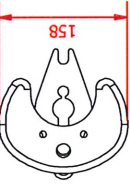

29-4W7 10441.QR

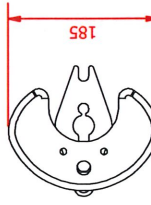

33-4W7 10441.QR



### PLANT ZONE 10cm

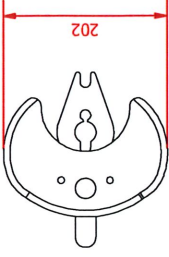

38-6W10 11681.QR

